

Fire prevention

Round-the-clock monitoring to ensure safety and security of guests.

A dedicated night watch who conduct checks on the entire boat every 15 minutes and are verified by a QR-based patrol system.

No charging of any electrical items is allowed in cabins. Charging is only permitted in dedicated areas.

Fire detection

Each cabin and communal area is equipped with smoke detectors and fire alarms to ensure early detection of fires.

At least two different systems on each boat to provide coverage in the event of an issue.

Alarms are tested regularly with test fully documented.

Detectors are installed in the corridors and engine room to provide warning in case of the presence of carbon monoxide.

Fire suppression

Each cabin equipped with 1kg fire extinguishers.

Fire blanket shields in all lower cabins, one per person

On the lower deck, upper deck, dive deck and crew room, we have 9kg powder fire extinguishers and foam fire extinguishers.

External water fire extinguishers, specialist kitchen extinguishers and large & automatic powder

extinguishers in the engine room mean we have firefighting solutions for various fire scenarios that may arise.

Diving and general safety

Each boat is equipped with emergency life rafts with sufficient space available for all guests and crew.

Each boat is equipped with a satellite phone to ensure a communication connection even in the most remote areas.

Passports are kept in a 'grab bag' so they can be easily removed in case of an emergency.

At least four trained first-aiders will be on board for every trip.

There are 2x50 litre and 1x12 litre oxygen cylinders on every boat.

Emergency action

Each cabin has an illuminated emergency plan and the boat has luminous directional signage to highlight the way to fire exits.

Emergency lighting is in place in the lower corridors.

The on-board welcome briefing shows guests all emergency exits so they can familiarise themselves with the different escape options, of which there are always two.

Drills are conducted and documented regularly to demonstrate the necessary procedures in case of emergency

Guests will be shown the location of life jackets on the boat. There will always be life jackets at the muster station.

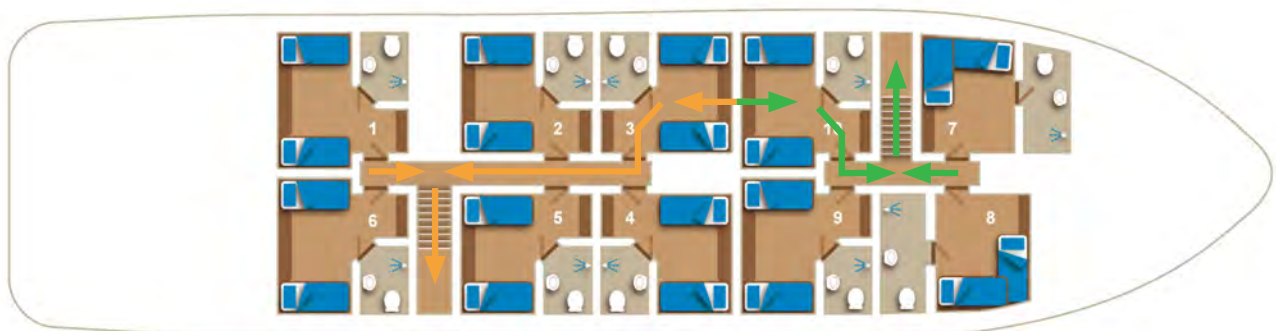

Example evacuation plan (Emperor Superior)